



ETOSHA VILLAGE
ENTRANCE TO NAMIBIA'S ANIMAL KINGDOM
*Affordable Luxury at the
Entrance to Etosha National
Park near Okaukuejo*



www.etosha-village.com

Etosha Village is situated only 2km before the Andersson entrance gate to Etosha National Park, near Okaukuejo. Prime destination for nature lovers combined with excellent service and cuisine!

Etosha Village uniquely combines affordability with comfort and style in a private and protected reserve directly adjacent to Namibia's animal kingdom.

At Etosha Village nature and luxury are in perfect harmony through design and comfort. Besides the 45 accommodation units, Etosha Village has three restaurant seating areas, a unique bar with a big screen television, two sparkling pools plus a kiddie pool as well as a fully stocked utility and curio shop.

GENERAL INFORMATION

Game drives to Etosha National Park are offered in custom made game viewer vehicles.

The well-stocked, on-site utility store "One Stop Cuca Shop" caters for all basic needs.

The 45 air-conditioned accommodation units are spread out in the gold and green Mopani forest ensuring maximum privacy.

LOCATION

Northern Namibia, 2km from the Andersson entrance gate to the famous Etosha National Park.

DISTANCE FROM:

Desert Camp - 750km
 Windhoek - 415km
 Okahandja - 344km
 Swakopmund via Omaruru - 540km
 Tsumeb via Etosha - 220km (*Speed Limits*)
 Tsumeb via Otjiwarongo - 360km
 Okaukuejo - 20km
 Outjo - 100km
 Otjiwarongo - 170km
 Omaruru - 305km
 Namutoni - 140km
 Khorixas - 225km

ONGAVA AIRFIELD

Coordinates S19°19'44" E015°54'50", compacted gravel

FACILITIES

- 3 Restaurant Seating Areas
- Fully stocked utility and curio shop
- Unique Bar area with big screen television
- 2 Swimming pools plus a kiddie pool
- Waterhole

MAP

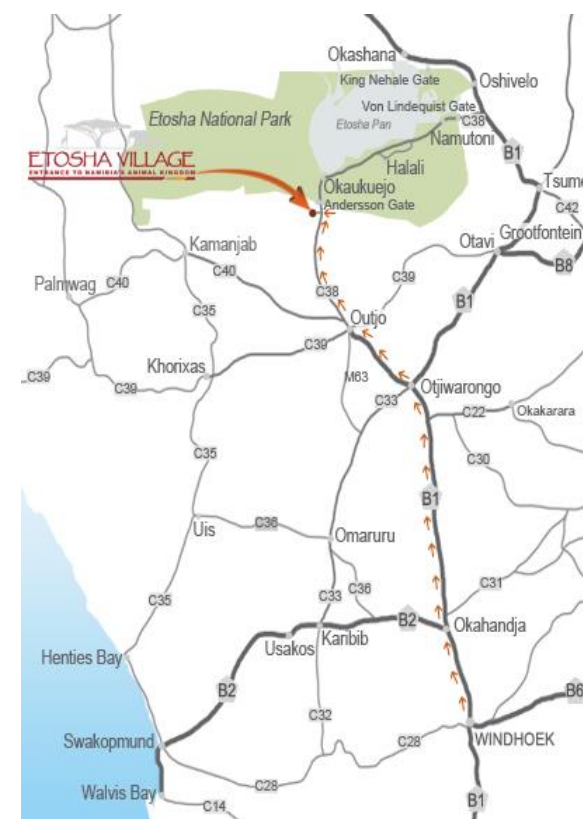

GPS Coordinates: S 19°21' 8.374" E 15°55' 47.855"



ACTIVITIES

Explore Namibia's animal kingdom with guided Game Drives to Etosha National Park. Guests can choose from morning or full-day excursions in custom built game viewer vehicles.

Enjoy the Guided Nature Walks on our reserve where various small game can be spotted from the lookout decks and hides.

Sundowner Drives and Stargazing Sessions allow guests to experience the magic of our sunsets and famous star studded skies.

ACCOMMODATION

Uniquely positioned amidst indigenous trees, the accommodation units at Etosha Village ensure maximum privacy and tranquillity.

The 45 individual luxurious suites offer a spacious air-conditioned bedroom and a modern en-suite bathroom with shower. Each twin-bedded room features a fridge, coffee- and tea making facilities, electronic safe, as well as a sleeper couch where 2 small children (under 12 years) can be accommodated when sharing with their parents.

The patio and outside seating are creates an ideal space to sit back, relax and enjoy the beauty that surrounds you.

Wheelchair friendly units are available and are equipped with a ramp instead of stairs, a more

spacious bathroom for easy wheelchair access and the room has a different interior arrangement for easier access.

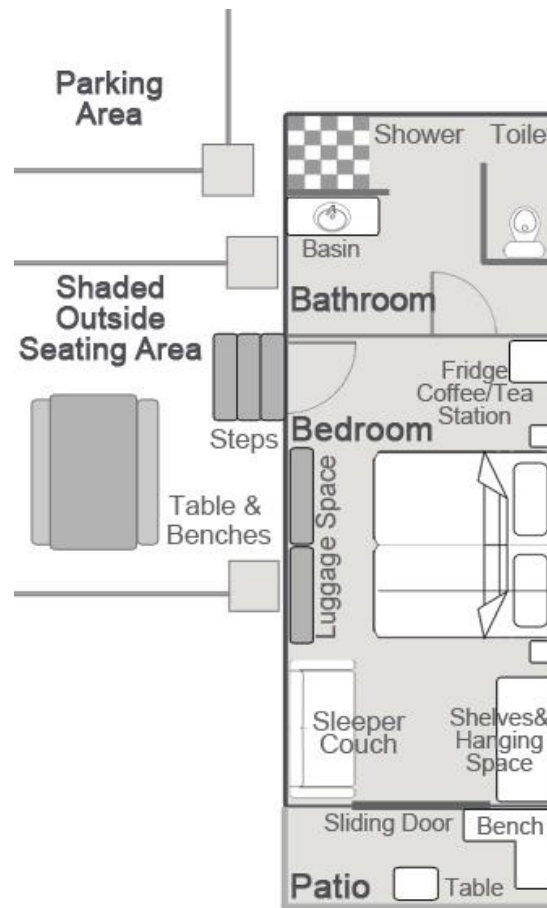

SEASONS

Low season:

1 December - 30 June excluding 24, 25 and 31 December

High season:

1 - 30 November and 1 July - 31 October including 24, 25 and 31 December

RESTAURANT

Breakfast, lunch and dinner may be ordered and enjoyed in the Etosha Village restaurant. The exceptional and extremely popular Breakfast and Dinner buffet are included with the accommodation booking.

Lunch or breakfast packs can be ordered the evening before at reception to take along on self-drives or guided excursions to Etosha National Park.

AWARDS

Etosha Village won several Awards of Excellence in the various categories by the Hospitality Association of Namibia.

Eco Award winner - Acknowledged for adhering strictly to water saving measures, water recycling, indigenous plant growth, wood of intruder trees used at the units, solar water heaters and nature conservation.



CHILD POLICY

Two children under 12 years can be accommodated free of charge on sleeper couch, if accompanying and sharing a room with 2 full paying adults (subject to availability).

CREDIT CARDS

Master and Visa credit cards are welcome.

OWNERS

Taleni Africa Tourism Holdings (Pty) Ltd

GENERAL MANAGER

Hein Vosloo

RESERVATIONS

Central Reservations Office

Tel: +27 21 930 4564
Fax: +27 21 914 9930

Email: reservations@etosha-village.com

Address: P.O. Box 5798, Tygervalley, 7536
Cape Town - South Africa

DIRECT DEPOSIT BANKING DETAILS

Bank: Bank Windhoek
Branch Code: 481-972
Account Name: Taleni Africa t/a Etosha Village
Account Type: Cheque
Account Number: 8001772920
Swift Code: BWL INA NX

Enter the Booking Number on the deposit slip and fax confirmation of deposit to +27 21 914 9930.

OTHER INFORMATION

Gardening

The recycled water affords us the possibility to have our own vegetable gardens. In their free time some members of our staff enjoy gardening and so supply the lodge with fresh herbs and seasonable vegetable.

Wheelchair Units

2 units tailored to the needs of the handicapped and wheelchairs.

Staff

Most of our staff members were unemployed and were recruited at a village nearby. Some have not previously worked while some was totally illiterate, middle aged with very little chance to make an acceptable living.

All new recruits were transported to our sister lodge, Sossusvlei Lodge, almost 800km away, to be trained in their various positions. Together with

some key staff of Sossusvlei Lodge and Desert Camp they returned to Etosha Village to take up their new employment and move into the newly renovated farm house with new beds and uniforms for them.

Most guests comment on the friendliest staff experienced during their entire holiday!

TERMS AND CONDITIONS

Quoted rates may change without prior notice should government taxes, fuel prices and other fees increase drastically and unexpectedly. Please confirm all rates.

- All quoted rates are in Namibian Dollars and are inclusive of 15% VAT
- Rates, where stated, are nett and are non-commissionable.
- Rates are quoted per room per night.
- Tariffs quoted are subject to change without prior notice.
- Private reservations will only be regarded as "confirmed" once the stipulated deposit has been received.
- Taleni Africa reserves the right to release a reservation if the due deposit is not received in full by the stipulated deposit due date.
- Full settlement of accommodation reservations must be made 30 days prior to arrival.



The following cancellation policy applies to all reservations:

Cancellation period: Cancellation fee

16 to 30 days prior to arrival: 50%

11 to 15 days prior to arrival: 75%

<10 days prior to arrival: 100%

Non-arrivals: 100%

Tour Operators should contact the Central Reservations Office regarding details of registration.

ETOSHA VILLAGE CONTACT DETAILS

Tel: +264 67 333 413

Fax: +264 67 333 414

E-mail: info@etosha-village.com

PO Box 6900, Ausspannplatz, Windhoek – Namibia

www.etosha-village.com

